



CITY OF NAPOLEON
BUILDING & ZONING DEPARTMENT
255 W. Riverview Avenue, PO Box 151, Napoleon, OH 43545
Phone: 419-592-4010 - Fax: 419-599-8393

APPLICATION FOR SIGN PERMIT

LOCATION OF PROPERTY: 810 Scott Street

OWNER NAME: Emanuel Lutheran Church PHONE: 419-592-2666

OWNER ADDRESS: 810 Scott Street, Napoleon, OH

CONTRACTOR NAME: Church members PHONE: Chairperson, Darlene Bostelman 419-599-1490

IS CONTRACTOR REGISTERED WITH THE CITY OF NAPOLEON? YES NO

SIGN INFORMATION

TYPE: POST WALL GROUND AWNING

DIMENSIONS: 4' x 8' = TOTAL S.F. _____

** PLEASE INCLUDE ANY AND ALL SITE PLANS AND PLANS OF ABOVE SIGNS.

FEES:

\$35.00 BASE UP TO 50 S.F. OF SIGN, PLUS \$0.20 PER ADDITIONAL S.F., NOT TO EXCEED \$150.00

\$5.00 FLAT FEE FOR TEMPORARY SIGNS, TEMPORARY SPECIAL EVENT SIGNS, AND PORTABLE SIGNS OTHER THAN THOSE EXEMPT FROM FEE.(SEE BELOW)

NO FEE REQUIRED FOR TEMPORARY AND EASILY REMOVABLE 1ST AMENDMENT SIGNS, OR SIGNS RELATED TO RELIGIOUS OR CHARITABLE CAUSES OR EVENTS.

Darlene Bostelman
APPLICANTS SIGNATURE

1-25-07
DATE

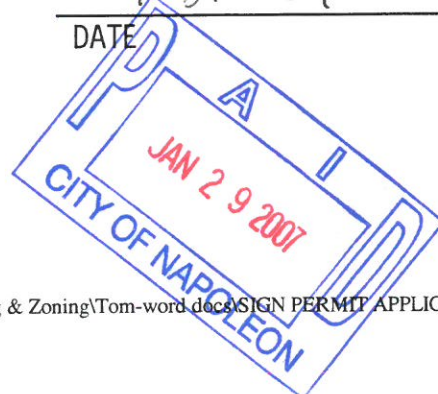

House

(PLAN A)

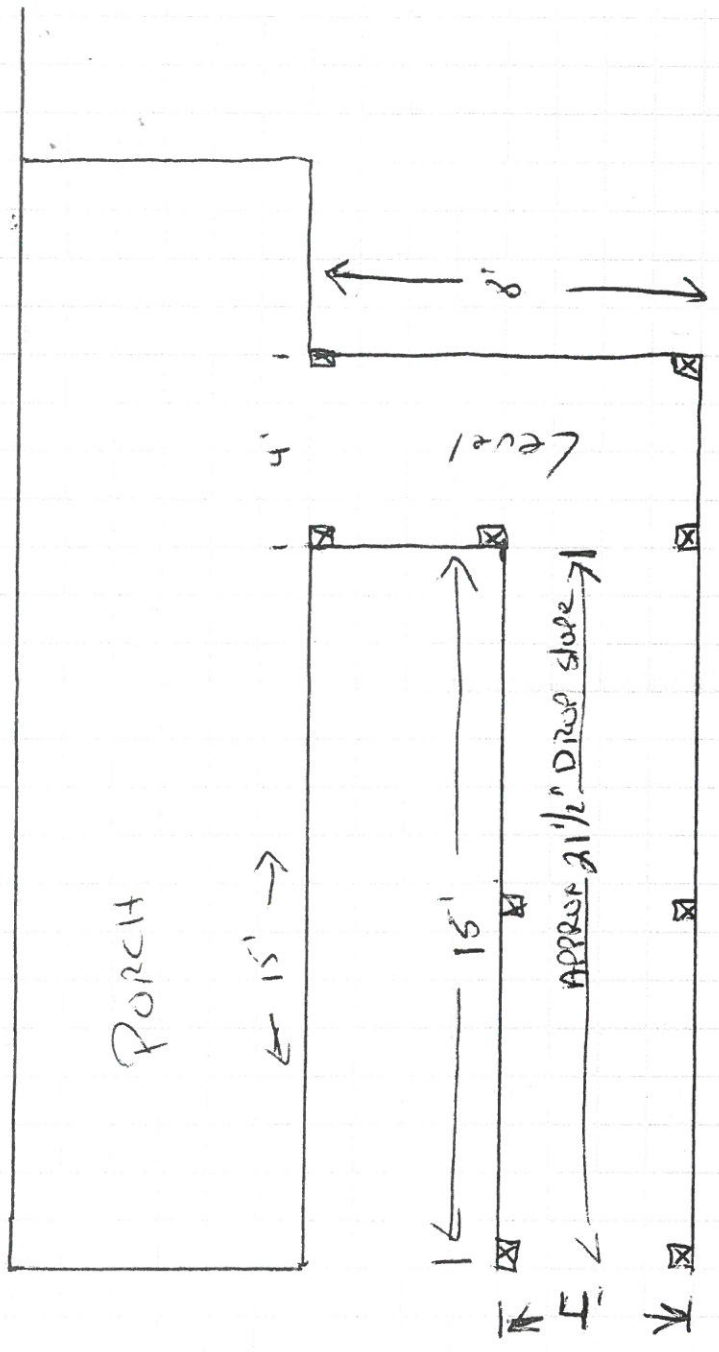

THIS IS THE PREFERRED METHOD
 2 1/2" DROP OVER 15'
 CAN POST SET TO INSIDE OF 4' WIDE RAMP?
 HOW DEEP MUST POST BE IN GROUND?

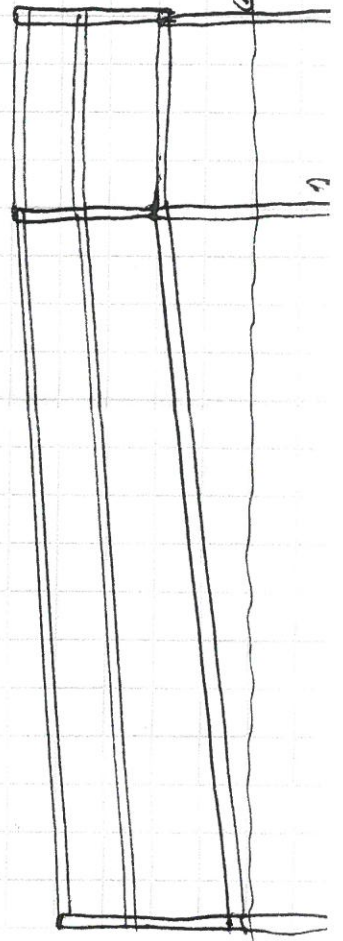

DRISSENEY

KERR REMODELING
 KEVIN KERR
 1-229-0-20
 DESHNER, CITRUS 43516
 119-278-2212

1" SCALE

Sheet

Scott

810
Scott



126

801

West

The bush+brick wall extends
 5.75' from church wall
 We will begin about 4' from bricks
 and 6' east of the tree towards the stairs